



With its minimum level of protrusion the installation buzzer 111 is ideal for control panel applications



Simple installation with single hole mounting for M22



TECHNICAL SPECIFICATIONS/ORDER SPECIFICATIONS:

Dimensions (Ø x Height):	50 mm x 22 mm (Protrusion from panel)	
Housing:	PC/ABS-Blend, black; Cap: PC	
Tone frequency:	C. 2,8 KHz	
Tone type:	Continuous or pulse tone	
Fixing:	Installation mounting for Ø 22,5 mm (M22 x 1.5 mm)	
Connection:	Connector plug with screw terminal max. 1.5 mm²	
Life duration:	> 5,000 hrs	
Assembly:	Nut and seal included in assembly	

Voltage:	24 V DC	230 V AC
Current consumption:	20 mA	20 mA
Continuous tone	111 000 55	111 000 68



TECHNICAL DIAGRAM:

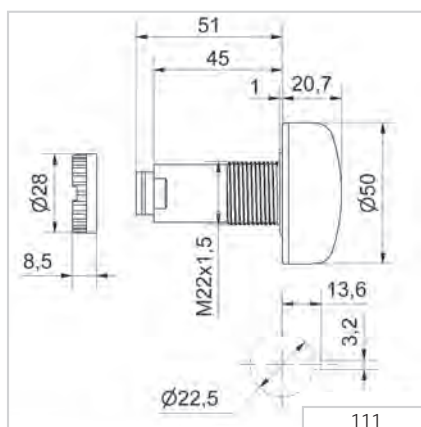

Signalisation index

Continuous tone	3
Pulse tone	4

