

010

**LAMPADINE, PRESSACAVI
ED ACCESSORI**

**LAMPS, CABLE GLANDS AND
ACCESSORIES**

Lampadine Lamps

BA9S Led luce fissa BA9S Steady light led lamps

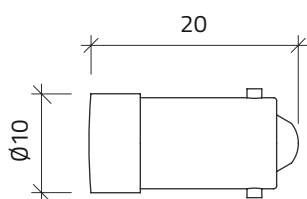

	g	n	cod
6V AC-DC			
● Rosso / Red	2	5	010BA9SLR6
● Giallo / Yellow	2	5	010BA9SLG6
● Verde / Green	2	5	010BA9SLV6
● Blu / Blue	2	5	010BA9SLBL6
○ Bianco / White	2	5	010BA9SLB6
12V AC-DC			
● Rosso / Red	2	5	010BA9SLR12
● Giallo / Yellow	2	5	010BA9SLG12
● Verde / Green	2	5	010BA9SLV12
● Blu / Blue	2	5	010BA9SLBL12
○ Bianco / White	2	5	010BA9SLB12
24V AC-DC			
● Rosso / Red	2	5	010BA9SLR24
● Giallo / Yellow	2	5	010BA9SLG24
● Verde / Green	2	5	010BA9SLV24
● Blu / Blue	2	5	010BA9SLBL24
○ Bianco / White	2	5	010BA9SLB24
36V AC-DC			
● Rosso / Red	2	5	010BA9SLR36
● Giallo / Yellow	2	5	010BA9SLG36
● Verde / Green	2	5	010BA9SLV36
● Blu / Blue	2	5	010BA9SLBL36
○ Bianco / White	2	5	010BA9SLB36
48V AC-DC			
● Rosso / Red	2	5	010BA9SLR48
● Giallo / Yellow	2	5	010BA9SLG48
● Verde / Green	2	5	010BA9SLV48
● Blu / Blue	2	5	010BA9SLBL48
○ Bianco / White	2	5	010BA9SLB48
130V AC-DC			
● Rosso / Red	2	5	010BA9SLR110
● Giallo / Yellow	2	5	010BA9SLG110
● Verde / Green	2	5	010BA9SLV110
● Blu / Blue	2	5	010BA9SLBL110
○ Bianco / White	2	5	010BA9SLB110
240V AC-DC			
● Rosso / Red	2	5	010BA9SLR240
● Giallo / Yellow	2	5	010BA9SLG240
● Verde / Green	2	5	010BA9SLV240
● Blu / Blue	2	5	010BA9SLBL240
○ Bianco / White	2	5	010BA9SLB240
400V AC-DC			
● Rosso / Red	2	5	010BA9SLR400
● Giallo / Yellow	2	5	010BA9SLG400
● Verde / Green	2	5	010BA9SLV400
● Blu / Blue	2	5	010BA9SLBL400
○ Bianco / White	2	5	010BA9SLB400

Lampadine

Lamps

BA9S Led luce fissa BA9S Steady light led lamps

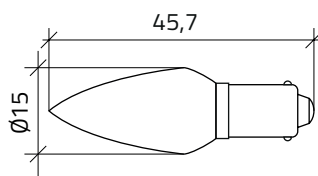

24V AC-DC

	g	cod
● Rosso / Red	2	010BA9ALR24
● Giallo / Yellow	2	010BA9ALG24
● Verde / Green	2	010BA9ALV24
● Blu / Blue	2	010BA9ALBL24
○ Bianco / White	2	010BA9ALB24

240V AC-DC

● Rosso / Red	2	010BA9ALR220
● Giallo / Yellow	2	010BA9ALG220
● Verde / Green	2	010BA9ALV220
● Blu / Blue	2	010BA9ALBL220
○ Bianco / White	2	010BA9ALB220

Led <60V non polarizzati 110-240 V polarizzati Led lamps <60V non-polarized 110-240 V polarized

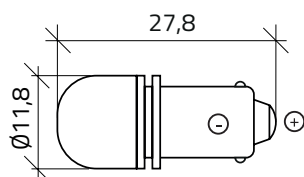

Led luce lampeggiante / Flashing light led

Led ultraluminoso tensioni $\pm 15\%$ non polarizzata / Ultra-bright led, voltage $\pm 15\%$ non-polarized
AC-DC 6 12 24 48 110 AC 220 mA 30 20 14 7 5 16

24V AC-DC

● Rosso / Red	2	010BA9SLLR24
---------------	---	--------------

130V AC-DC

● Rosso / Red	2	010BA9SLLR110
---------------	---	---------------

240V AC-DC

● Rosso / Red	2	010BA9SLLR220
---------------	---	---------------

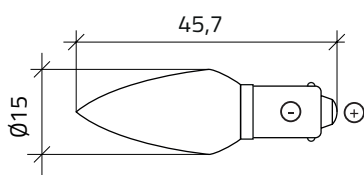

24V AC-DC

● Rosso / Red	2	010BA9ALLR24
---------------	---	--------------

Nuove lampade due colori , tecnologia led alta luminosità New bi-colour led lamps,high brightness

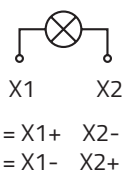

24V DC 15mA

1 2		
● ● Verde, rosso / Green, red	2	010BA9SLVR24
● ● Verde, giallo / Green, yellow	2	010BA9SLVG24
● ● Blu, rosso / Blue, red	2	010BA9SLBLR24
● ● Blu, giallo / Blue, yellow	2	010BA9SLBLG24

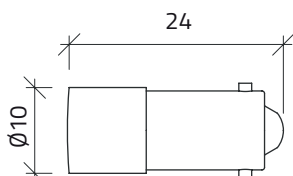

Lampadine Lamps

BA9S Lampadine ad incandescenza BA9S Incandescent lamps

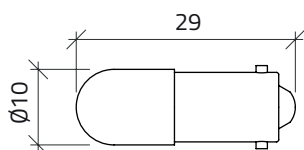

			g	n	cod
	6V	0,6W	1,3	10	010BA9S6V-0.6W
	24V	1,2 W	1,3	10	010BA9S24V-1.2W
	24V	3W	1,3	10	010BA9S24V-3W
	30V	1,2W	1,3	10	010BA9S30V-1.2W
	30V	3W	1,3	10	010BA9S30V-3W
	48V	1,2W	1,3	10	010BA9S48V-1.2W
	60V	1,2 W	1,3	10	010BA9S60V-1.2W
	60V	3W	1,3	10	010BA9S60V-3W
	110V	1,9W	1,3	10	010BA9S130V-1.9
	220V	2W	1,3	10	010BA9S220V-2W

BA9S Lampadine al neon / BA9S neon lamps

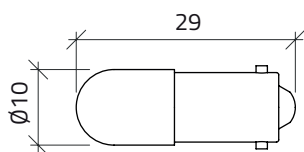

			g	n	cod
Neon AC					
● Arancio / Orange	65V	0,05W	2,3	10	010BA9SN65
● Arancio / Orange	130V	0,1W	2,3	10	010BA9SN110
● Verde / Green	130V	0,1W	2,3	10	010BA9NV110
● Arancio / Orange	240V	0,3W	2,3	10	010BA9SN220
● Verde / Green	240V	0,3W	2,3	10	010BA9NV220
● Arancio / Orange	400V	0,5W	2,3	10	010BA9SN380
● Verde / Green	400V	0,5W	2,3	10	010BA9NV380

BA15D Lampadine led / BA15D led lamps

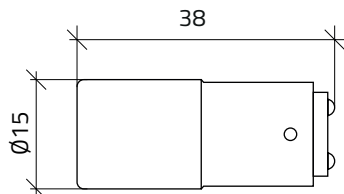

		g	cod
24V AC-DC			
○ Bianco / White		2	010BA15DLB24
230V AC-DC			
○ Bianco / White		2	010BA15DLB220

Chiavi Keys

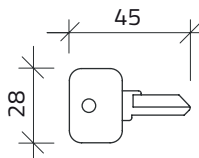
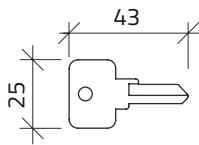

Chiavi / Keys

	g	c	n	cod
	11	3095	2	010K95
	11	3353	2	010K53
	11	9901	2	010K01
	11	9902	2	010K02
	11	9903	2	010K03
	11	9904	2	010K04
	11	9905	2	010K05
	11	9910	2	010K10
	11	9916	2	010K16
	11	9919	2	010K19

Versione secondo normativa FIAT / Version according to FIAT standards

● Nero / Black	11	73034	2	010K34
● Rosso / Red	11	73037	2	010K37
● Giallo / Yellow	11	73033	2	010K33
● Blu / Blue	11	73038	2	010K38
● Arancio / Orange	11	73040	2	010K40

Pressacavi in termoplastico

Thermoplastic cable glands

010

Pressacavi / Cable glands

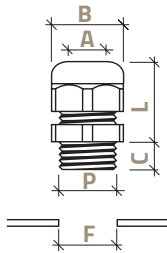

Poliammide PA6 autoestinguente cl. V2 (UL94) - Temperatura di impiego -20°/+90°
 V2 (UL94) self-extinguishing PA6 polyamide - Operating temperature -20°/+90°

	P	g	F	A	B	C	L	cod
● Nero / Black	M12 x 1,5	4	12,5	3-6,5	15	8	25	010NM12
● Nero / Black	M16 x 1,5	7	16,5	5-10	22	10	32	010NM16
● Nero / Black	M20 x 1,5	11	20,5	6-12	24	10	32	010NM20
● Nero / Black	M20 x 1,5	11	20,5	10-14	27	10	32	010NM20A
● Nero / Black	M25 x 1,5	16	25,5	13-18	33	10	38	010NM25
● Nero / Black	M32 x 1,5	23	32,5	18-25	42	15	43	010NM32
● Nero / Black	PG7	4	12,5	3-6,5	15	8	25	010NPG7
● Nero / Black	PG9	6	15,5	4-8	19	8	27	010NPG9
● Nero / Black	PG11	9	19	5-10	22	8	32	010NPG11
● Nero / Black	PG11	9	19	4-7	22	8	32	010NPG11R
● Nero / Black	PG13,5	11	20,5	6-12	24	10	32	010NPG13
● Nero / Black	PG16	13	22,5	10-14	27	10	32	010NPG16
● Nero / Black	PG21	21	29	13-18	33	12	38	010NPG21
○ Bianco / White	PG29	27	38	18-25	42	11	35-40	010NPG29

Pressacavo 2 ingressi / 2-hole cable gland

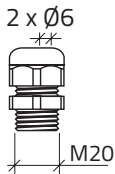

g	cod
10	0102P20

Pressacavo 2 vie / Double entry cable gland

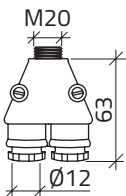

45	010N2M20
----	-----------------

Pressacavi con spirale / Spiral cable glands

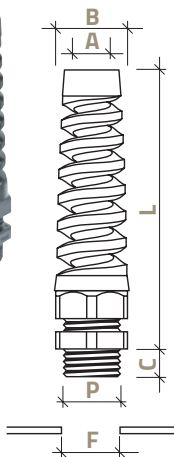

Poliammide PA6 autoestinguente cl. V2 (UL94) - Temperatura di impiego -20°/+90°
 V2 (UL94) self-extinguishing PA6 polyamide - Operating temperature -20°/+90°

	P	g	F	A	B	C	L	cod
M12 x 1,5	7	12,5	3-6,5	15	8	58		010FM12
M16 x 1,5	10	16,5	5-10	22	10	83		010FM16
M20 x 1,5	19	20,5	6-12	24	10	96		010FM20
M20 x 1,5	19	20,5	10-14	27	10	96		010FM20A
M25 x 1,5	33	25,5	13-18	33	10	119		010FM25
PG11	16	19	5-10	22	8	83		010FPG11
PG13,5	19	20,5	6-12	24	10	96		010FPG13
PG16	25	22,5	10-14	27	10	106		010FPG16
PG21	25	29	13-18	33	11	119		010FPG21



Tappi, riduzioni e controdadi in termoplastico

Thermoplastic hole plugs, reducers and locknuts

Tappi di chiusura / Hole plugs

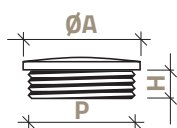

P	ØA	H	g	cod
Polistirene PS - Temperatura di impiego -20°/+60° PS Polystyrene - Operating temperature -20°/+60°				
M12 x 1,5	15	10	1	010TM12
M16 x 1,5	19,5	10	2	010TM16
M20 x 1,5	25	10	2,4	010TM20
M25 x 1,5	30	10	4	010TM25
M32 x 1,5	37	10	4,2	010TM32
PG7	15	10	1	010TPG7
PG9	19,5	10	1,5	010TPG9
PG11	22	10	2	010TPG11
PG13,5	25	10	2	010TPG13
PG16	27	10	3	010TPG16
PG21	33	10	4	010TPG21

Riduzioni in plastica / Plastic reducers

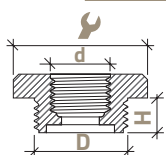

D	d	H	g	cod	
M25	M12	10	29	8	010RM25M12

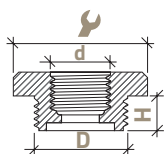

M25	M16	10	32	9	010RM25M16
-----	-----	----	----	---	------------

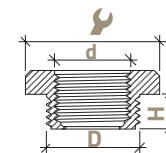

M25	M20	10	32	7,8	010RM25M20
-----	-----	----	----	-----	------------

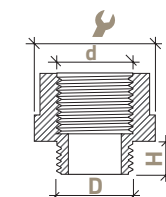

M20	M25	10	32	6,8	010RM20M25
-----	-----	----	----	-----	------------

Controdadi / Locknuts

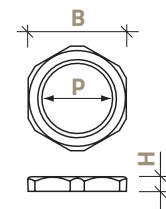

P	B	H	g	n	cod
Poliammide PA6 autoestinguente cl. V2 (UL94) - Temperatura di impiego -20°/+90° V2 (UL94) self-extinguishing PA6 polyamide - Operating temperature -20°/+90°					
● Nero / Black	M12 x 1,5	18	5	10	010DM12
● Nero / Black	M16 x 1,5	24	6	1,5	010DM16
● Nero / Black	M20 x 1,5	27	6	2	010DM20
● Nero / Black	M25 x 1,5	34	7	3	010DM25
● Nero / Black	M32 x 1,5	41	7	4	010DM32
● Nero / Black	PG7	19	5	1	010DPG7
● Nero / Black	PG9	22	5	2	010DPG9
● Nero / Black	PG11	24	5	2	010DPG11
● Nero / Black	PG13,5	27	6	2,5	010DPG13
● Nero / Black	PG16	30	6	3	010DPG16
● Nero / Black	PG21	36	7	3,5	010DPG21
○ Bianco / White	PG29	46	7,5	5	010DPG29

Valvole di ventilazione anticondensa

Ventilation plugs (to prevent condensation)

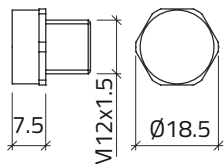

Permeabilità all'aria / Air permeability 2lt./min.Δp =70mbar
 Pressione ingresso acqua / Water inlet pressure max 0,2 bar / 60 s

● Nero / Black

1,5

10

010VV

g n cod

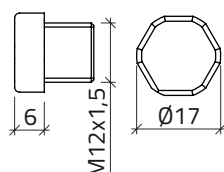

Permeabilità all'aria / Air permeability 0,4it./min.Δp =70mbar
 Pressione ingresso acqua / Water inlet pressure max 0,6 bar / 60 s

● Grigio / Grey

1,5

010VV400

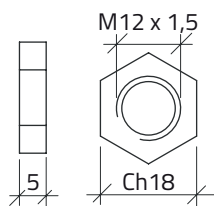

● Nero / Black

0,7

10

010DM12

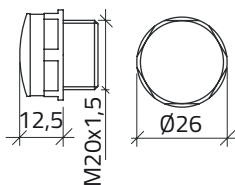

Permeabilità all'aria / Permeability to air 12,5lt./min.Δp =70mbar
 Pressione ingresso acqua / Water inlet pressure max 0,1 bar / 60 s

● Nero / Black

6,0

010VV12500

g cod

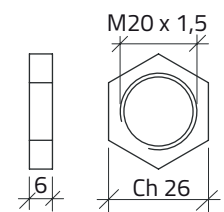

● Nero / Black

2

010DM20

Valvole di drenaggio Drain plugs

Valvola di drenaggio Drain plugs

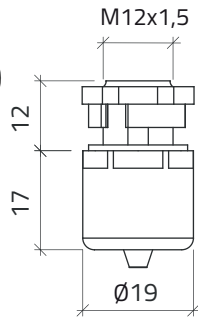

Valvola con dado / Plugs and special lock nut
Poliammide / Polyamide

● Nero / Black

g n cod

5

010VD

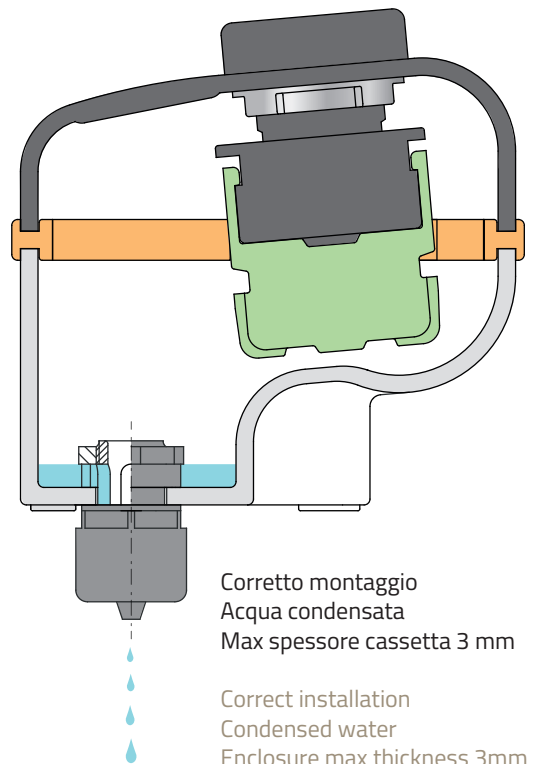

Cavi USB

USB cables

Cavo mt 0,8
Cable mt 0,8

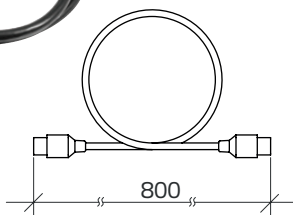

Tipo M-M (maschio-maschio)
Type M-M (male-male)

● Nero / Black

g

cod

37

010CUSBMM8

Cavo mt 2
Cable mt 2

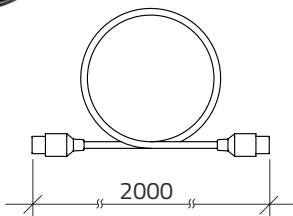

Tipo M-M (maschio-maschio)
Type M-M (male-male)

● Nero / Black

g

cod



77

010CUSBMM20





Pressacavi e riduzioni in metallo OTTONE NICHELATO

Metal cable glands and adapters NICKEL-PLATED BRASS

g	D			L	cod
Pressacavi / Cable glands					
14	M16x1,5	5 ÷ 9	18	17	010POM16
20	M20x1,5	8 ÷ 12	22	22	010POM20
34	M25x1,5	11 ÷ 16	28	28	010POM25
50	M32x1,5	15 ÷ 21	35	35	010POM32



Raccordo a gomito 45° / Elbow fittings to 45°

g	D			L	cod
26	M16x1,5	11,5	19	10	010GIM16
38	M20x1,5	15	23	10	010GIM20
55	M25x1,5	20	28	10	010GIM25
90	M32x1,5	27	36	10	010GIM32

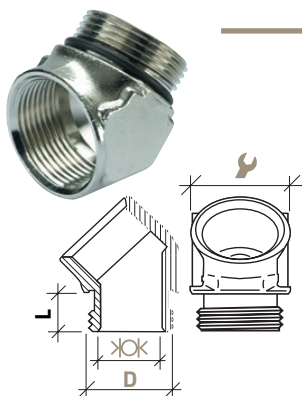

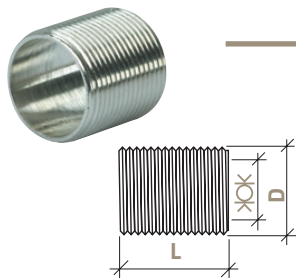

Nippli / Nipples

g	D		L	cod
8	M16x1,5	12	21	010NPM16
20	M20x1,5	15	24,5	010NPM20
18	M25x1,5	20	25	010NPM25
30	M32x1,5	26	32	010NPM32



Riduzioni / Adapters

g	D			L	cod
18	M16x1,5	12	22	12	010BM16
22	M20x1,5	15	26	14	010BM20
20	M25x1,5	21	30	14	010BM25
28	M32x1,5	28	40	15	010BM32

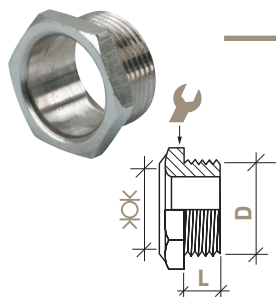





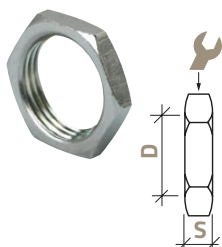

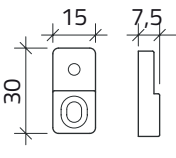

Controdadi / Locknuts

g	D		S	cod
4	M16x1,5	19	3	010GM16
6	M20x1,5	24	3,5	010GM20
12	M25x1,5	30	3,5	010GM25
26	M32x1,5	36	4,5	010GM32

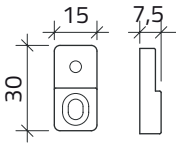

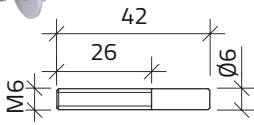
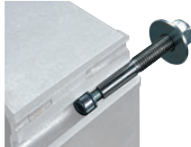
Accessori per scatole pulsantiere

Accessories for push-button enclosures

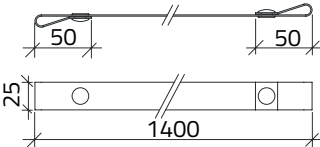
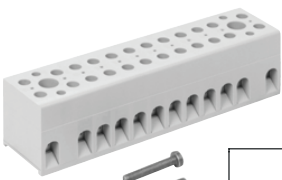
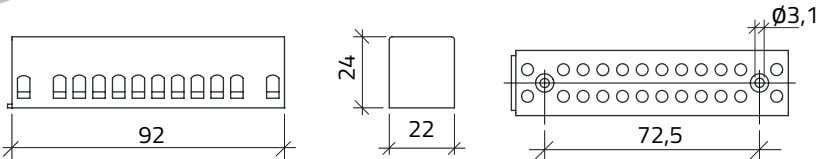
		L	g	cod
 	Kit di staffe di fissaggio 10 mm Set of mounting brackets 10 mm		28	010S10
 	Kit di staffe di fissaggio 25mm Set of mounting brackets 25 mm		32	010S25
  	Kit di fissaggio con prigionieri (M4/M10) Fixing kit with (M4/M10) studs		26	010SFP
 	Guida / PVC Rail Ø 35	2000	760	010GDP
 	Cinghia tracolla / Shoulder belt 25X1400 mm		46	010CT25
 	Morsettiera 12 poli Terminal block 12 poles		86	010M12